

Features

Platform 1	25'	210°
Platform 2	27'	216°
Deep Point	128'	216°
Lone Pine Tree	30'	253°
Pine Trees	20'	300°
Quarry Equip.	100'	178°

Jim Egonrieder - 1997

Mt. Storm Lake
Dive Training Area

Mt. Storm, WV
Elevation 3244 ft

This area off-limits to divers

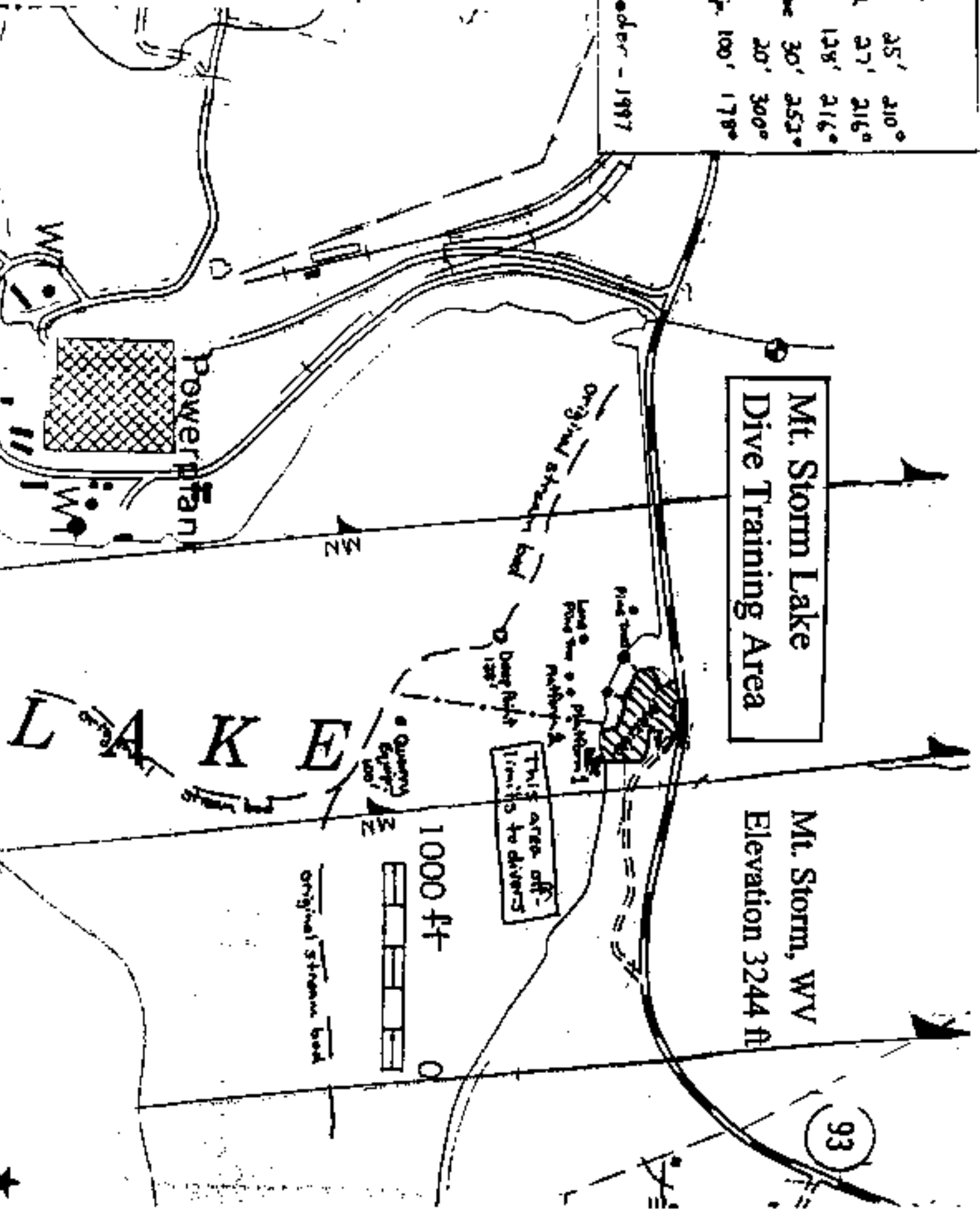

L A K E

1000 ft

93